

STUNNING SUMMER PROJECT: FLAT

395 000 €

Ref 7753321

Ixelles - Apartment 560 sq ft

**VANEAU
LECOBEL**
Real Estate Brussels



About this property

Vaneau-Lecobel is pleased to present this charming one-bedroom flat of approximately 52 m², situated on the 2nd floor of this development, ideally located on Rue de l'Ât in Ixelles, within easy reach of shops, public transport and all amenities. The property comprises an entrance hall, a bright living room with an open-plan kitchen of approximately 25 m², a separate toilet, a utility room and a bedroom of approximately 15 m² with an en-suite shower room. Residents have access to the development's communal areas, which include a shared lounge, a gym, a communal laundry room, a garden and cellars. The building also features a lift and an extensive green roof. The property is sold subject to completion of the deed of sale. The sale is subject to VAT, with the possibility of applying the reduced rate of 6%. For further information, please contact us on 02/669.21.70 or at promotion@vaneau-lecobel.be.

VANEAU LECOBEL NEW PROJECTS

Georges Brugmann Square

10B 1050 Ixelles

ph +32 2 669 21 70

✉ promotion@lecobel.be

Reference : 7753321

Price : 395 000 €

Surface : 560 sq ft

Bedroom(s) : 1

Floor : 2

Bathroom(s) : 1

Cellar : Yes

Elevator : Yes

STUNNING SUMMER PROJECT: FLAT

395 000 €

Ref 7753321

Ixelles - Apartment 560 sq ft

**VANEAU
LECOBEL**
Real Estate Brussels



STUNNING SUMMER PROJECT: FLAT

STUNNING SUMMER PROJECT: FLAT

395 000 €

Ref 7753321

Ixelles - Apartment 560 sq ft

VANEAU
LECOBEL
Real Estate Brussels

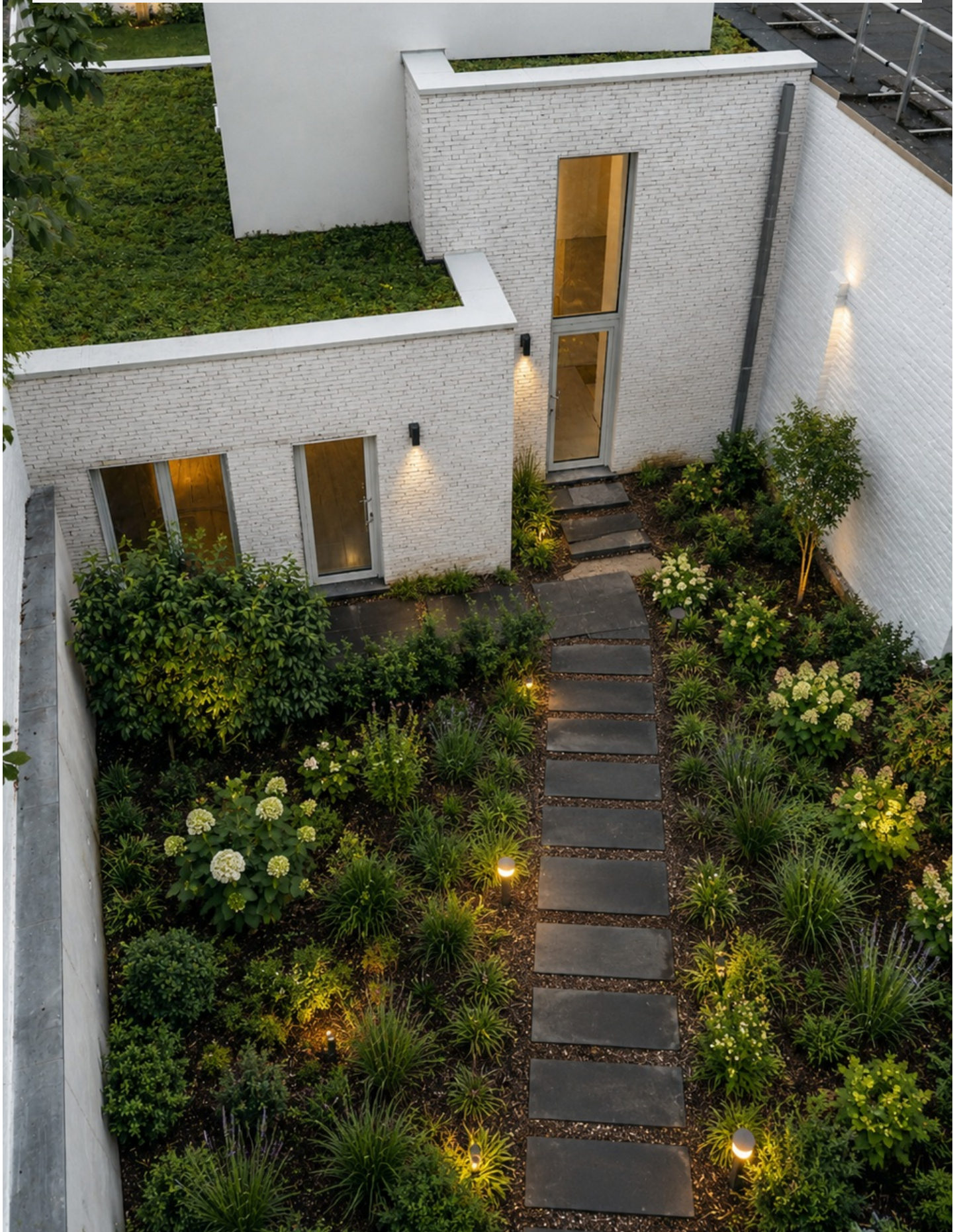



VANEAU

Immobilier de prestige depuis
1972

VANEAU LOCATION

Une équipe dédiée à Paris,
Neuilly et Boulogne

VANEAU VIAGER

30 ans d'expérience en vente
viagère

VANEAU C'EST AUSSI

VANEAU BUREAUX & COMMERCES

+10 000 offres disponibles

VANEAU PATRIMOINE

Dispositifs de défiscalisation,
SCPI, Assurances Vie

VANEAU DIGITAL NEUF

La plate-forme digitale 100%
immobilier neuf

COURTAGE CRÉDITS

Exell Crédit immobiliers
Assurances emprunteurs

GESTION LOCATIVE

GTF, plus de 7 000 lots gérés à
Paris

140 collaborateurs

1200 signatures par an

1000 immeubles par an

2.5 milliards d'actifs gérés