

JOURDAN SQUARE - STUNNING FLAT APPROX. 75M² - TERRACE

406 000 €

Ref 7717554

Etterbeek - Apartment 807 sq ft

**VANEAU
LECOBEL**
Real Estate Brussels



About this property

Vaneau Lecobel is pleased to present this elegant residential development in Etterbeek, ideally located within walking distance of the European Quarter and the renowned Place Jourdan. This distinctive project combines architectural heritage, contemporary design and modern living comfort. The development comprises 30 apartments, ranging from studios to 4-bedroom units, with surface areas from approximately 54 sqm to 234 sqm. Designed with respect for the existing heritage, selected original façades and structures have been preserved, giving the project a unique character. The apartments offer generous living spaces, abundant natural light and high-quality finishes. Particular attention has been paid to sustainability, featuring excellent energy performance, premium materials and landscaped green areas within the inner courtyard. Located in one of Brussels's most sought-after neighbourhoods, close to shops, restaurants, public transport and Leopold Park, the project enjoys an

VANEAU LECOBL NEW PROJECTS

Georges Brugmann Square
10B 1050 Ixelles

ph +32 2 669 21 70

✉ promotion@lecobel.be

Reference : 7717554

Price : 406 000 €

Surface : 807 sq ft

Bedroom(s) : 1

Floor : 2

exceptional living environment. Whether for owner-occupation or investment purposes, this development represents a rare opportunity in Brussels. Completion is scheduled for the end of 2027. For further information: +32 2 669 21 70 à promotion@lecobel.be.

Bathroom(s) : 1

Garden : Yes

Cellar : Yes

Elevator : Yes

Parking(s) : 1

Terrace : Yes

JOURDAN SQUARE - STUNNING FLAT APPROX. 75M² - TERRACE

406 000 €

Ref 7717554

Etterbeek - Apartment 807 sq ft

**VANEAU
LECOBEL**
Real Estate Brussels





JOURDAN SQUARE - STUNNING FLAT APPROX. 75M² - TERRACE

406 000 €

Ref 7717554

Etterbeek - Apartment 807 sq ft

**VANEAU
LECOBEL**
Real Estate Brussels

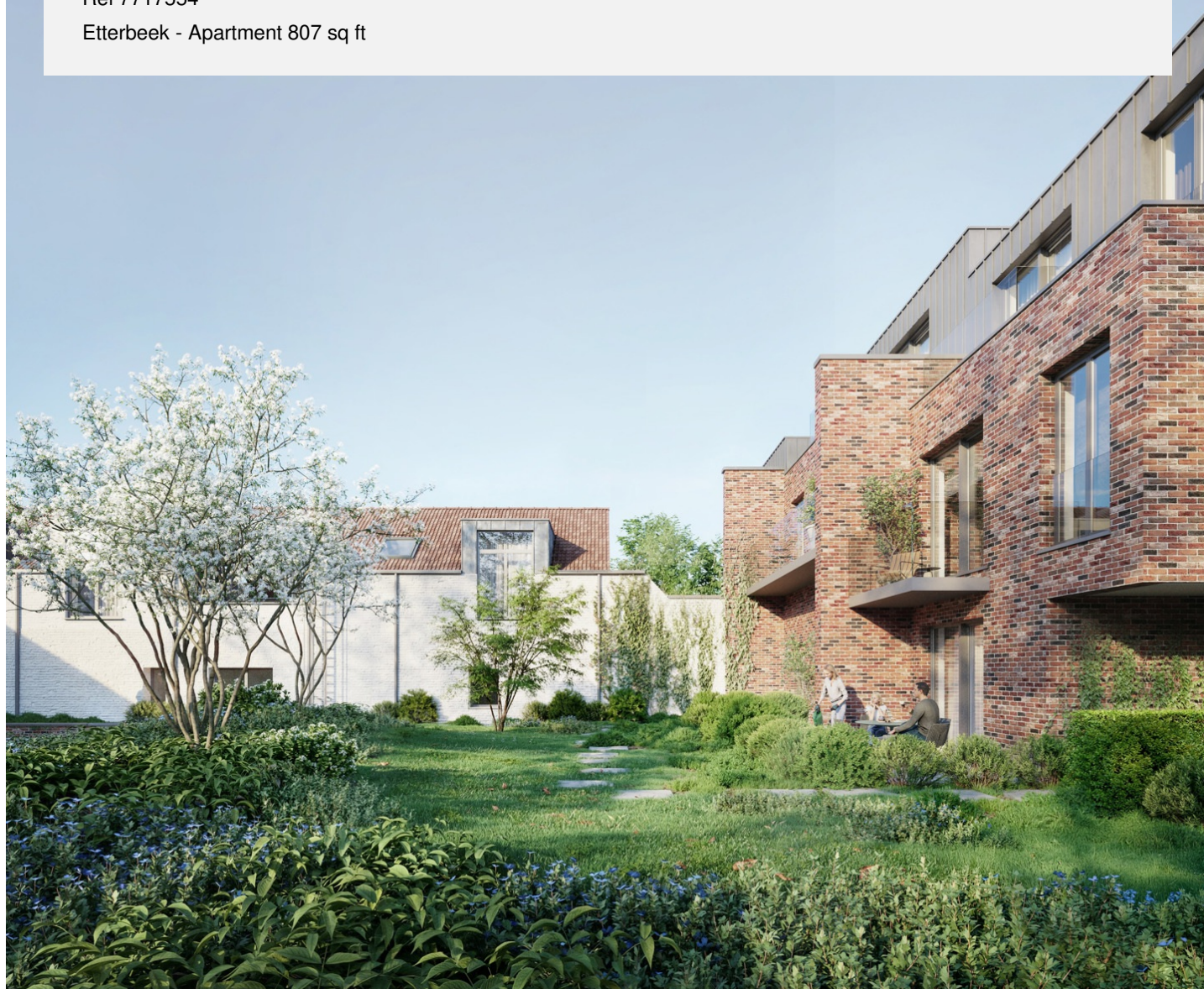



VANEAU

Immobilier de prestige depuis
1972

VANEAU LOCATION

Une équipe dédiée à Paris,
Neuilly et Boulogne

VANEAU VIAGER

30 ans d'expérience en vente
viagère

VANEAU C'EST AUSSI

VANEAU BUREAUX & COMMERCES

+10 000 offres disponibles

VANEAU PATRIMOINE

Dispositifs de défiscalisation,
SCPI, Assurances Vie

VANEAU DIGITAL NEUF

La plate-forme digitale 100%
immobilier neuf

COURTAGE CRÉDITS

Exell Crédit immobiliers
Assurances emprunteurs

GESTION LOCATIVE

GTF, plus de 7 000 lots gérés à
Paris

140 collaborateurs

1200 signatures par an

1000 immeubles par an

2.5 milliards d'actifs gérés