

# JOURDAN SQUARE - STUNNING FLAT APPROX. 87 M<sup>2</sup> - TERRACE

490 000 €

Ref 7717587

Etterbeek - Apartment 936 sq ft

**VANEAU  
LECOBEL**  
Real Estate Brussels



## About this property

Vaneau Lecobel is pleased to exclusively present this magnificent residential project ideally located in Etterbeek, in the immediate vicinity of the European Quarter and the highly sought-after Place Jourdan. This dual-aspect 2-bedroom apartment of approximately 87 sqm is composed as follows: entrance hall leading to a bright and inviting living area featuring the lounge, dining room, and a fully equipped open-plan kitchen, all oriented towards the front of the building. The night hall leads to a separate toilet, laundry area, technical room, and a bathroom equipped with a bathtub and single washbasin. At the rear, the two bedrooms benefit from a peaceful setting, with the master bedroom enjoying direct access to a  $\pm 9$  sqm terrace overlooking the gardens. Cellar included. High energy performance standards (EPB C+): rainwater recovery system, individual heat pump, underfloor heating, and double-flow ventilation system. The neighborhood enjoys a highly desirable setting, combining conviviality, mobility, and quality of life. In the immediate vicinity of the shops, restaurants, and amenities of the Jourdan district, residents will also benefit from the green surroundings of Parc L'Opold, as well as a rich cultural and educational environment. Delivery scheduled for the end of 2027. Contact us now for more information about this project at +32 2 669 21 70 or by email at [promotion@lecobel.be](mailto:promotion@lecobel.be)

## VANEAU LECOBEL NEW PROJECTS

Georges Brugmann Square  
10B 1050 Ixelles  
ph +32 2 669 21 70

✉ [promotion@lecobel.be](mailto:promotion@lecobel.be)

**Reference :** 7717587

**Price :** 490 000 €

**Surface :** 936 sq ft

**Bedroom(s) :** 2

**Floor :** 1

**Bathroom(s) :** 2

**Garden :** Yes

**Cellar :** Yes

**Elevator :** Yes

**Parking(s) :** 1

**Terrace :** Yes

# JOURDAN SQUARE - STUNNING FLAT APPROX. 87 M<sup>2</sup> - TERRACE

490 000 €

Ref 7717587

Etterbeek - Apartment 936 sq ft

**VANEAU  
LECOBEL**  
Real Estate Brussels





# JOURDAN SQUARE - STUNNING FLAT APPROX. 87 M<sup>2</sup> - TERRACE

490 000 €

Ref 7717587

Etterbeek - Apartment 936 sq ft

**VANEAU  
LECOBEL**  
Real Estate Brussels

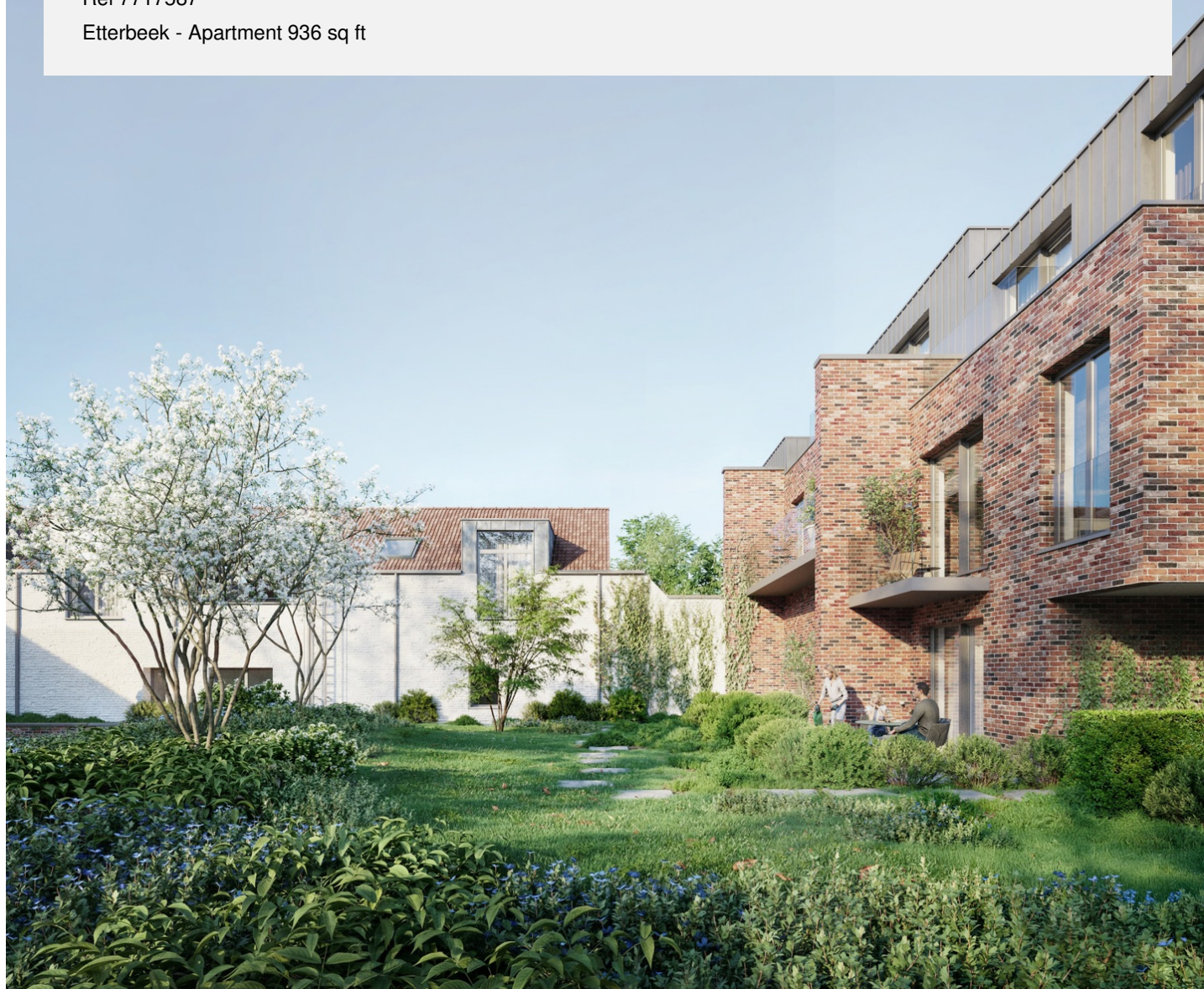



## **VANEAU**

Immobilier de prestige depuis  
1972

### **VANEAU LOCATION**

Une équipe dédiée à Paris,  
Neuilly et Boulogne

### **VANEAU VIAGER**

30 ans d'expérience en vente  
viagère

# **VANEAU C'EST AUSSI**

### **VANEAU BUREAUX & COMMERCES**

+10 000 offres disponibles

### **VANEAU PATRIMOINE**

Dispositifs de défiscalisation,  
SCPI, Assurances Vie

### **VANEAU DIGITAL NEUF**

La plate-forme digitale 100%  
immobilier neuf

### **COURTAGE CRÉDITS**

Exell Crédit immobiliers  
Assurances emprunteurs

### **GESTION LOCATIVE**

GTF, plus de 7 000 lots gérés à  
Paris

**140 collaborateurs**

**1200 signatures par an**

**1000 immeubles par an**

**2.5 milliards d'actifs gérés**