

# JOURDAN SQUARE - STUNNING FLAT APPROX. 69M<sup>2</sup> - TERRACE

390 000 €

Ref 7717590

Etterbeek - Apartment 743 sq ft

**VANEAU  
LECOBEL**  
Real Estate Brussels



## About this property

Vaneau Lecobel is pleased to present this magnificent residential project ideally located in Etterbeek, in the immediate vicinity of the European Quarter and the highly sought-after Place Jourdan. This dual-aspect 1-bedroom apartment  $\hat{A}\pm 69$  m<sup>2</sup> is composed as follows: entrance hall with cloakroom area, separate toilet, and shower room equipped with a shower and single washbasin. At the front of the apartment, a bright and inviting living area features the lounge, dining room, and a fully equipped open-plan kitchen, complemented by a laundry space and technical room. At the rear, the bedroom enjoys direct access to a beautiful south-facing terrace overlooking a green roof, offering a peaceful and verdant setting. Cellar included. High energy performance standards (EPB A-): rainwater recovery system, individual heat pump, underfloor heating, and double-flow ventilation system. The neighborhood enjoys a highly desirable setting, combining conviviality, mobility, and quality of life. In the

## VANEAU LECOBEL NEW PROJECTS

Georges Brugmann Square  
10B 1050 Ixelles

ph +32 2 669 21 70

✉ [promotion@lecobel.be](mailto:promotion@lecobel.be)

**Reference :** 7717590

**Price :** 390 000 €

**Surface :** 743 sq ft

**Bedroom(s) :** 1

**Floor :** 1

immediate vicinity of the shops, restaurants, and amenities of the Jourdan district, residents will also benefit from the green surroundings of Parc L'Éopold, as well as a rich cultural and educational environment. Delivery scheduled for the end of 2027. Contact us now for more information about this project at +32 2 669 21 70 or by email at [promotion@lecobel.be](mailto:promotion@lecobel.be)

**Bathroom(s) :** 1

---

**Cellar :** Yes

---

**Elevator :** Yes

---

**Parking(s) :** 1

---

**Terrace :** Yes

# JOURDAN SQUARE - STUNNING FLAT APPROX. 69M<sup>2</sup> - TERRACE

390 000 €

Ref 7717590

Etterbeek - Apartment 743 sq ft

**VANEAU  
LECOBEL**  
Real Estate Brussels





# JOURDAN SQUARE - STUNNING FLAT APPROX. 69M<sup>2</sup> - TERRACE

390 000 €

Ref 7717590

Etterbeek - Apartment 743 sq ft

**VANEAU  
LECOBEL**  
Real Estate Brussels

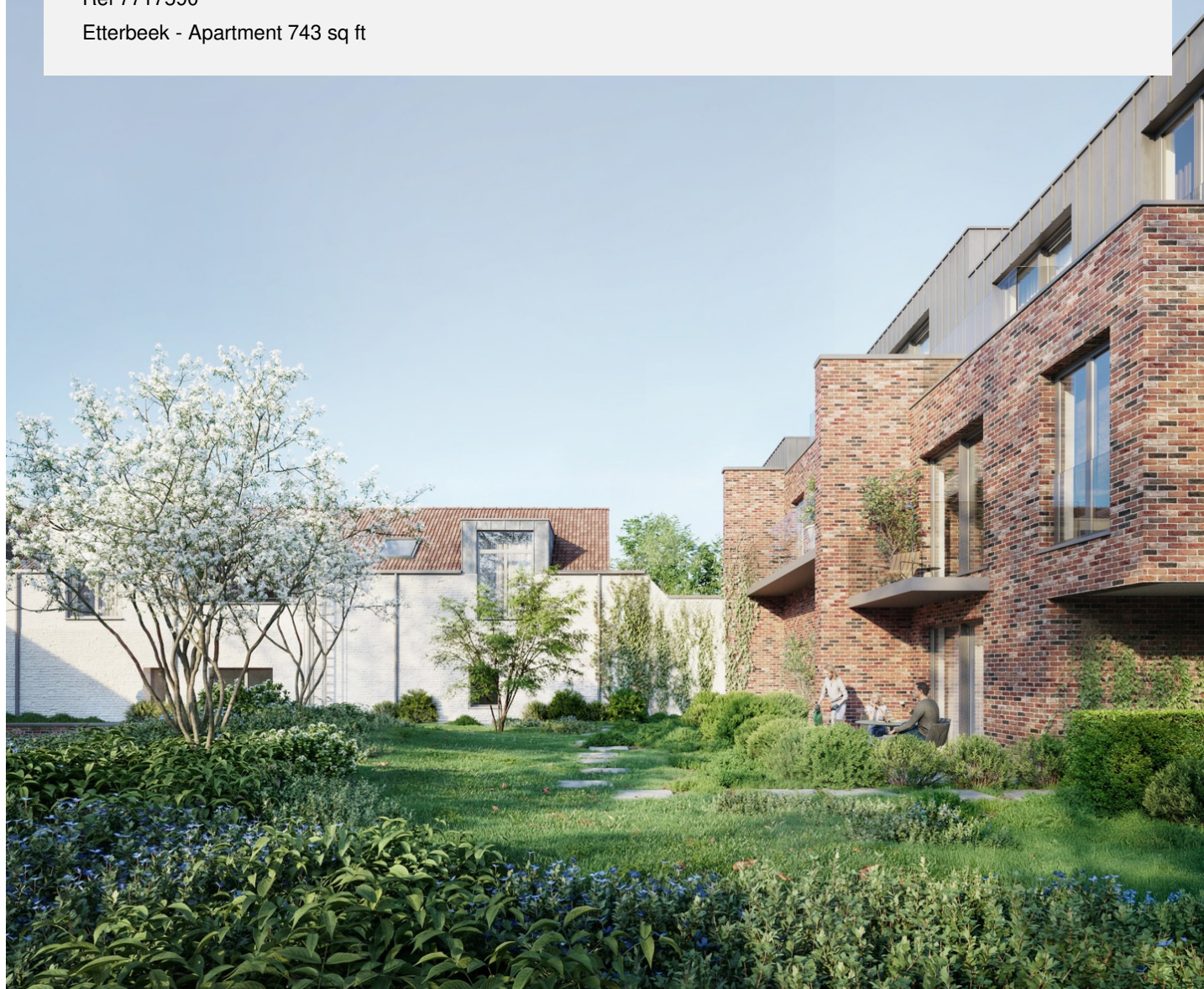



## **VANEAU**

Immobilier de prestige depuis  
1972

### **VANEAU LOCATION**

Une équipe dédiée à Paris,  
Neuilly et Boulogne

### **VANEAU VIAGER**

30 ans d'expérience en vente  
viagère

# **VANEAU C'EST AUSSI**

### **VANEAU BUREAUX & COMMERCES**

+10 000 offres disponibles

### **VANEAU PATRIMOINE**

Dispositifs de défiscalisation,  
SCPI, Assurances Vie

### **VANEAU DIGITAL NEUF**

La plate-forme digitale 100%  
immobilier neuf

### **COURTAGE CRÉDITS**

Exell Crédit immobiliers  
Assurances emprunteurs

### **GESTION LOCATIVE**

GTF, plus de 7 000 lots gérés à  
Paris

**140 collaborateurs**

**1200 signatures par an**

**1000 immeubles par an**

**2.5 milliards d'actifs gérés**